

# IFS-8 INTEGRATED OIL STORAGE, FILTRATION AND DISPENSING UNIT



NOTE:  
Drum adapter kit is not included with the system.



IFS-8 INTEGRATED OIL, FILTRATION AND DISPENSE SYSTEM Includes;

- (4) 265 liter, 11 gauge steel tanks
  - (4) 1/2 H.P., 120 VAC/1PH TEFC gear pumps - up to 5 GPM(US) depending on viscosity.
- Dedicated Start/Stop motor control for each pump conveniently located on the front of the system.

NOTE: If oil viscosity is above ISO 320 oil @ 20°C, lower speed pumps are required that will deliver 1.5 to 2 GPM(US) to prevent the pumps from cavitating the oil.

- 4 HMK05 double length spin-on filter assemblies with visual condition indicators.
- NOTE: THERE IS ONE PUMP AND ONE FILTER DEDICATED TO EACH TANK TO PREVENT CROSS CONTAMINATION AND PROVIDE MAXIMUM CLEANLINESS.
- Ergonomic Dispensing Station complete with drip tray positioned at a comfortable working height with removable perforated metal platform and 1/2" ball valve drain.
- 300 liter fabricated 11 gauge steel containment with 2" NPT drain ports on both sides.
- 4 dedicated spring return dispense valves.
- 4 dedicated 2 position, 1/4 turn directional flow control valves
- #One position delivers oil to the dispense valves.
- #Two positions delivers oil to the on-board tanks for fill or circulation operations.
- Remote LED level gauges conveniently mounted on the front of the system where they are easily viewed for level checks and monitoring during dispense and fill operations.
- 4 dedicated suction hose assemblies with quick couplers for connection to on-board tanks or remote drums or reservoirs. Integral fixed hose hanger with quick couplers to mate with hose quick couplers. Keeps hoses neatly stored and out of the way when not in use.
- Complete manual with operating instructions and parts list.

**NOTE:**  
UNIT IS SHIPPED COMPLETELY ASSEMBLED.  
THAT INCLUDES COMPLETE ELECTRICAL ASSEMBLY AND  
ESA APPROVAL

DRAWN	RL	DATE	LUBRIGARD LTD. 1175 APPLEBY LINE BURLINGTON, ON L7L 5H9	PHONE: (905) 569-8600 E-MAIL: info.sales@lubrigard.com
CHECKED		6-FEB-25		
APPROVED			DWG TITLE IFS-8 INTEGRATED OIL STORAGE, FILTRATION AND DISPENSING UNIT	
SCALE			DWG NO IFS-8_SYSTEM_GROUP_V2	REV NO
CERTIFICATION			PAGE	ALT DWG NO
ESA - ELECTRICAL SAFETY AUTHORITY			PAGE 1 OF 6	



# IFS-8 INTEGRATED OIL STORAGE, FILTRATION AND DISPENSING UNIT

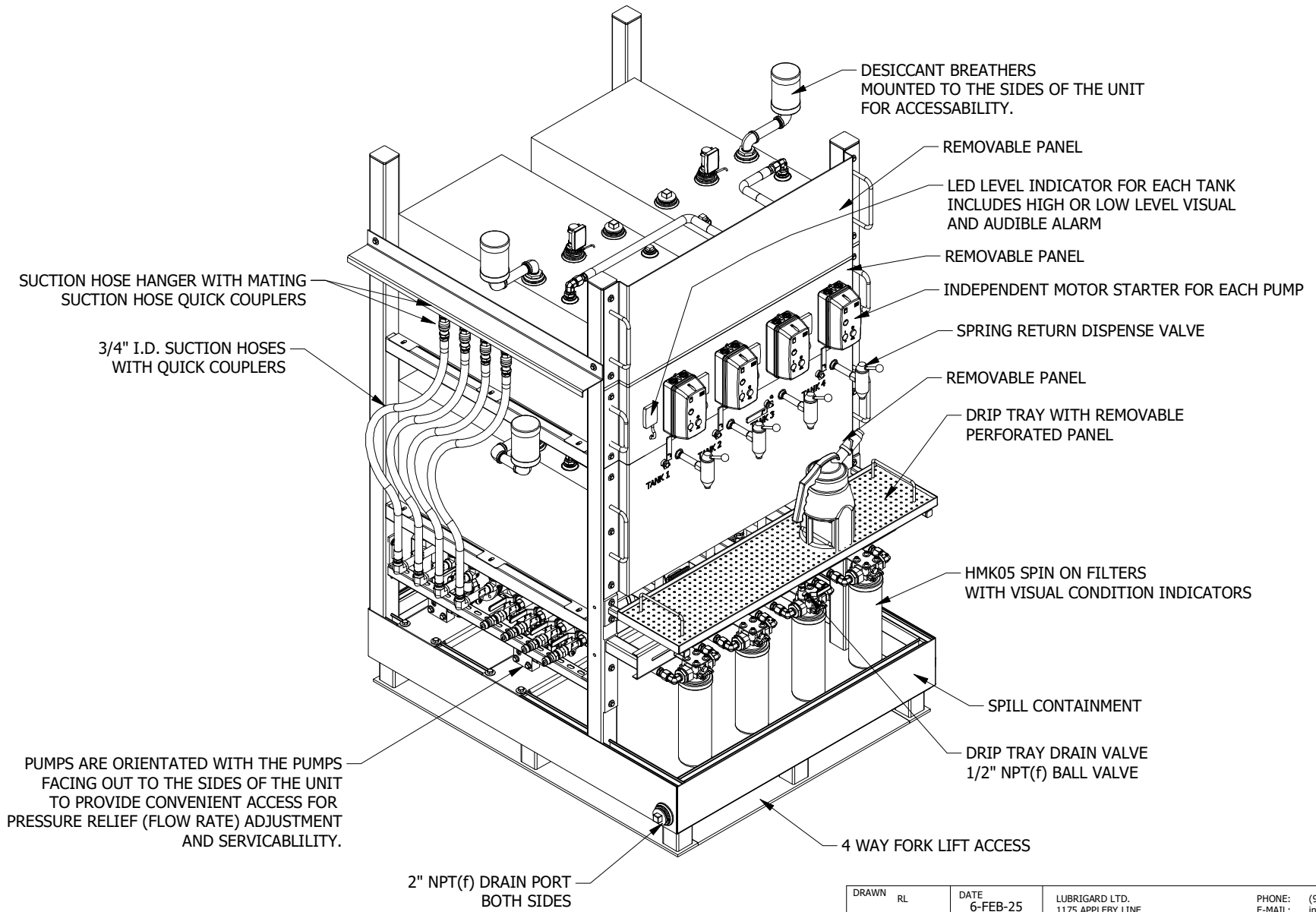

DRAWN	RL	DATE	6-FEB-25	LUBRIGARD LTD. 1175 APPLEBY LINE BURLINGTON, ON L7L 5H9	PHONE: (905) 569-8600 E-MAIL: info.sales@lubrigard.com
CHECKED					
APPROVED				DWG TITLE IFS-8 INTEGRATED OIL STORAGE, FILTRATION AND DISPENSING UNIT	REV NO
SCALE				DWG NO IFS-8_SYSTEM_GROUP_V2	
CERTIFICATION	ESA - ELECTRICAL SAFETY AUTHORITY			PAGE	PAGE 2 OF 6
					ALT DWG NO





**REMOTE LED LEVEL GAUGE**

- 1/8 TANK GRADUATIONS
- HIGH OR LOW LEVEL ALARM VISUAL AND AUDILE
- 9V STANDARD LITHIUM BATTERY OPERATED
- YELLOW FAULT LIGHT IF THERE IS A FAULT IN THE SYSTEM.



ALL PUMPS ARE ORIENTATED TO FACE THE SIDES OF THE CONTAINMENT TO PROVIDE ACCESS TO ALL PUMPS FOR PRESSURE RELIEF ADJUSTMENT AND PUMP SERVICING. NO CLEARANCE REQUIRED AT THE BACK OF THE SYSTEM.

- ALL PUMPS
- GEAR PUMPS UP TO 5 GPM DEPENDING ON VISCOSITY
  - 1/2 H.P. 120 VAC/1 PH TEFC

PUMP START/STOP 1 FOR EACH PUMP

300 LITER CONTAINMENT

4 WAY FORKLIFT ACCESS

**NOTE:**  
**THE SYSTEM IS SHIPPED COMPLETELY WIRED AND ESA APPROVED.**  
**END USER HAS TO BRING POWER CONNECTION TO THE 4 MOTOR STOP/START UNITS.**

**PUMP & MOTOR CONTROL ARRANGEMENT**

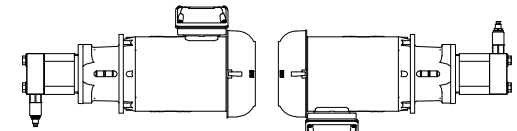

PUMP 2

PUMP 3

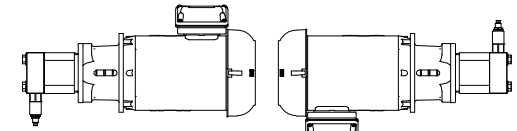

PUMP 1

PUMP 4

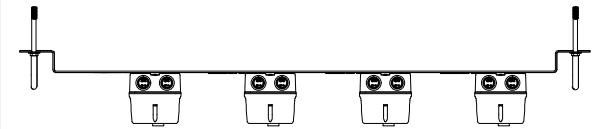

PUMP 1  
START/STOP

PUMP 2  
START/STOP

PUMP 3  
START/STOP

PUMP 4  
START/STOP



DRAWN	RL	DATE	6-FEB-25	LUBRIGARD LTD. 1175 APPLEBY LINE BURLINGTON, ON L7L 5H9	PHONE: (905) 569-8600 E-MAIL: info.sales@lubrigard.com
CHECKED					
APPROVED				DWG TITLE IFS-8 INTEGRATED OIL STORAGE, FILTRATION AND DISPENSING UNIT	REV NO
SCALE				DWG NO IFS-8_SYSTEM_GROUP_V2	
CERTIFICATION	ESA - ELECTRICAL SAFETY AUTHORITY		PAGE	PAGE 3 OF 6	ALT DWG NO

# IFS-8 INTEGRATED OIL STORAGE, FILTRATION AND DISPENSING UNIT CONTROLS PANEL

LED LEVEL GAUGE  
(see page 4 for details)

START/STOP  
PUMP MOTOR CONTROL

### DIRECTIONAL FLOW CONTROL VALVES

A simple and convenient 1/4 turn (90°) rotation of the valve handle directs oil flow to either the on-board tank or the dispense valve.

The valves are located on the controls panel for the system where they are;

- easy to access,
- beside the LED tank level indicator for easy viewing and tank level monitoring.
- beside the Start/Stop pump motor control for quick access during transfer or dispensing operations.

DIRECTIONAL FLOW CONTROL VALVES  
- VALVE HANDLE UPRIGHT POSITION  
OIL IS DIRECTED TO THE ON BOARD TANK.

- VALVE IN PARALLEL POSITIONS  
OIL IS DIRECTED TO THE DISPENSE SPIGOT

### NOTE:

Valves 1, 2 & 4 are positioned to direct oil flow into their on-board tanks.

Valve 3 is positioned to direct oil flow to dispense valve 3.

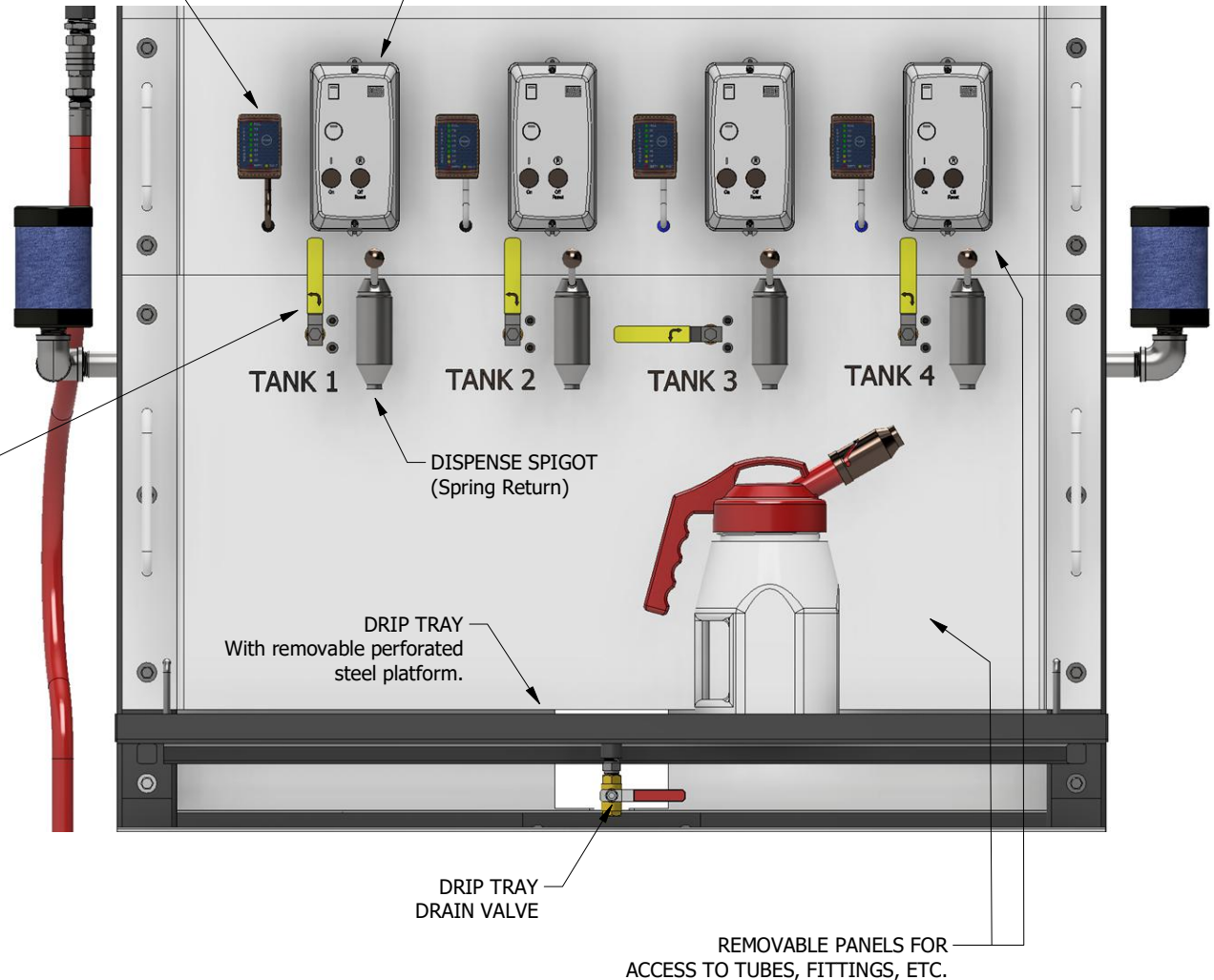

DRAWN RL	DATE 6-FEB-25	LUBRIGARD LTD. 1175 APPLEBY LINE BURLINGTON, ON L7L 5H9	PHONE: (905) 569-8600 E-MAIL: info.sales@lubrigard.com
CHECKED			
APPROVED		DWG TITLE IFS-8 INTEGRATED OIL SYSTEM - CONTROLS PANEL	
SCALE		DWG NO IFS-8_SYSTEM_GROUP_V2	REV NO
CERTIFICATION ESA - ELECTRICAL SAFETY AUTHORITY		PAGE PAGE 4 OF 6	ALT DWG NO



# IFS-8 INTEGRATED OIL STORAGE, FILTRATION AND DISPENSING UNIT INSTALLATION CLEARANCES

FRONT VIEW

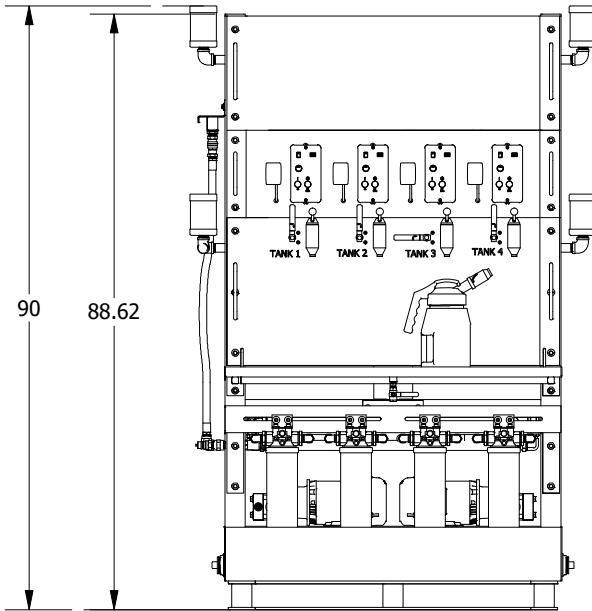

SIDE VIEW

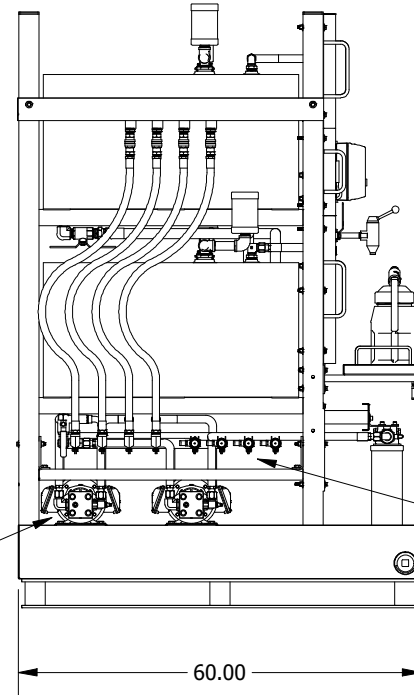

PUMPS, RELIEF VALVES AND PLUMBING ARE ACCESSABLE AT THE SIDES OF THE SYSTEM.

VALVES AND HOSE CONNECTIONS ARE ACCESSABLE ON THE SIDE OF THE SYSTEM.

TOP VIEW  
"0" CLEARANCE REQUIRED AT THE BACK OF THE SYSTEM.

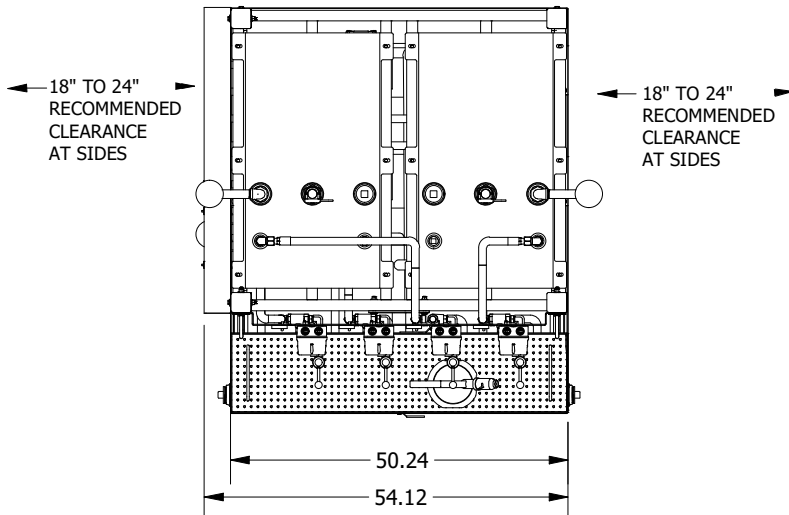

DRAWN RL	DATE 6-FEB-25	LUBRIGARD LTD. 1175 APPLEBY LINE BURLINGTON, ON L7L 5H9	PHONE: (905) 569-8600 E-MAIL: info.sales@lubrigard.com
CHECKED			
APPROVED		DWG TITLE IFS-8 INTEGRATED OIL SYSTEM - INSTALLATION CLEARANCES	
SCALE		DWG NO IFS-8_SYSTEM_GROUP_V2	REV NO
CERTIFICATION ESA - ELECTRICAL SAFETY AUTHORITY		PAGE PAGE 5 OF 6	ALT DWG NO





# IFS-8 INTEGRATED OIL STORAGE, FILTRATION AND DISPENSING UNIT

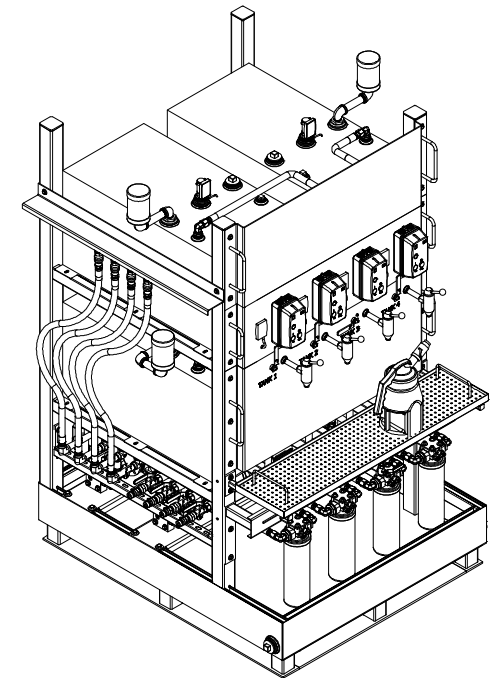
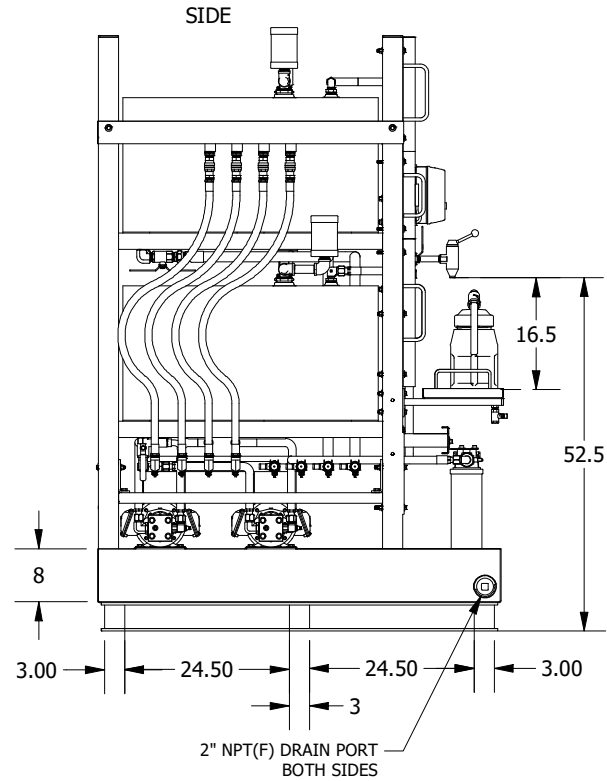
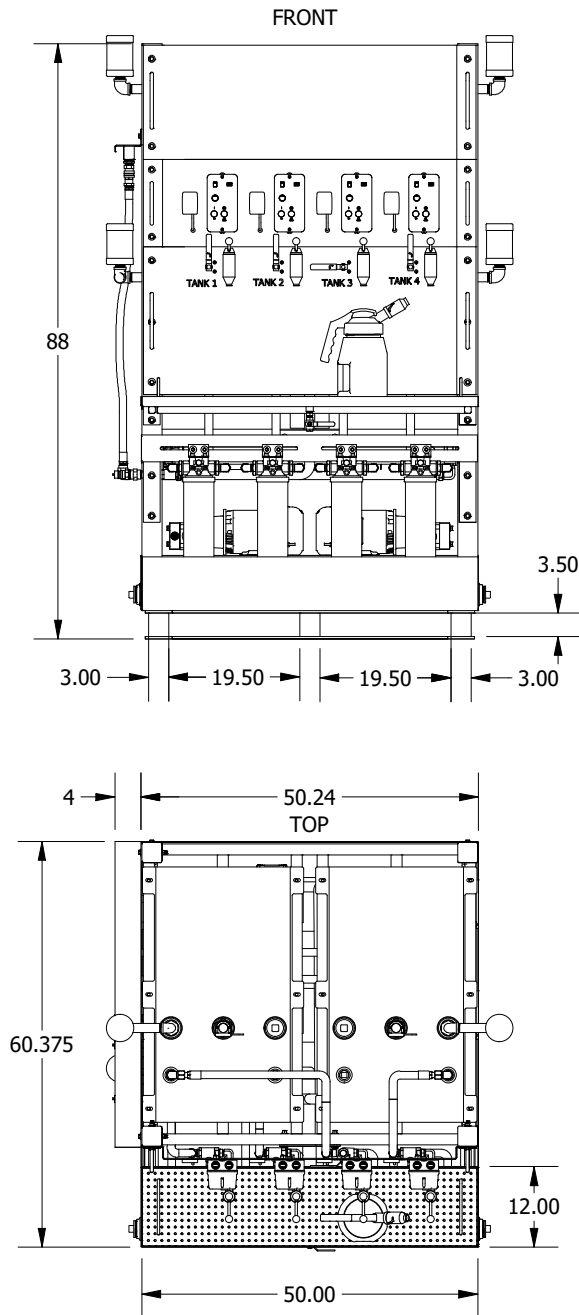

DRAWN	RL	DATE	6-FEB-25	LUBRIGARD LTD. 1175 APPLEBY LINE BURLINGTON, ON L7L 5H9	PHONE: (905) 569-8600 E-MAIL: info.sales@lubrigard.com
CHECKED					
APPROVED				DWG TITLE IFS-8 INTEGRATED OIL STORAGE, FILTRATION AND DISPENSING UNIT	REV NO
SCALE				DWG NO IFS-8_SYSTEM_GROUP_V2	
CERTIFICATION				PAGE	ALT DWG NO
ESA - ELECTRICAL SAFETY AUTHORITY				PAGE 6 OF 6	

